

RV Toilet Service Parts for Aria CLASSIC

- Phillips screwdriver
- Towels
- Short Phillips screwdriver

Notes

- Read all instructions before beginning work.
- Manufacturer recommends replacing both cables when one is broken.
- Avoid contact with human waste by wearing protective items such as gloves, glasses, long sleeves and nose/face mask. Wash toilet area you will be working on.
- To reduce holding tank odor: Rinse toilet with at least 1 gallon of water. Drain Holding Tank. Add appropriate dose of Thetford Holding Tank Deodorant.

Remove Toilet

1. Turn off RV water supply per RV Owner's Manual.
2. Pry off Bolt Caps with flat-blade screwdriver. Use wrench to remove 7/16 -inch Lag Screws.
3. Disconnect Water Supply Line with adjustable wrench.
4. Place an old towel or soft cloth on work surface. Remove Toilet from floor and place upside down, with back facing you, on work surface. Verbal instructions below (left, right, etc.) will assume this orientation, but the figures may not always do so.
5. Remove old Closet Flange Seal (may be found on Toilet or in floor at Closet Flange). Discard.
6. Cover Holding Tank opening to contain odor.

To Remove and Replace Old Parts

1. Loosen Clamp closest to Mechanism to remove Mounting Flange, Mounting Bushings, Outfall Tube (high-profile units only) and Hub Seal (Fig. A).
2. Actuate Pedal and hold. With other hand, hold Water Valve Actuator in open position (Fig. D) to release tension from Cable. Release Pedal. Push Right Cam Arm back in (Fig. B) and disconnect Cable End from it.
3. Actuate Pedal again, fully, and hold. Hold Blade Actuator in open position (Fig. D). Release Pedal to release tension from Cable. Push Left Cam Arm back in (Fig. B) and disconnect Cable End from it.
4. Pry Cable Sheath ends from Pedal bracket (Fig. B).
5. Using Phillips screwdriver, remove three screws (without washers) attaching Mechanism to Mechanism Plate (Fig. C).
6. Using short Phillips Screwdriver, remove standoff screw securing Mechanism to Mechanism Plate (Fig. D).
7. Lift Mechanism off Mechanism Plate enough to access the Cable Slots in Plate. Pry both Cable Sheath Fittings from their

Cable Package

Part No. 19835 High
Part No. 19836 Low

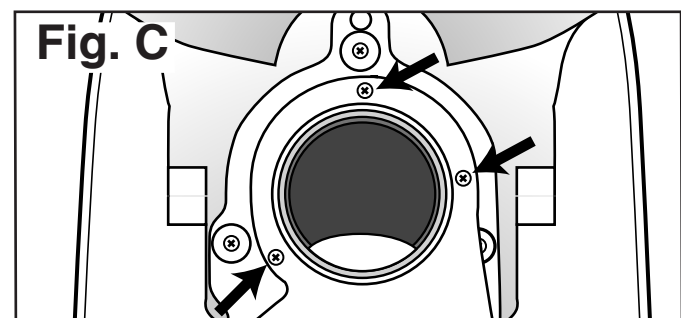
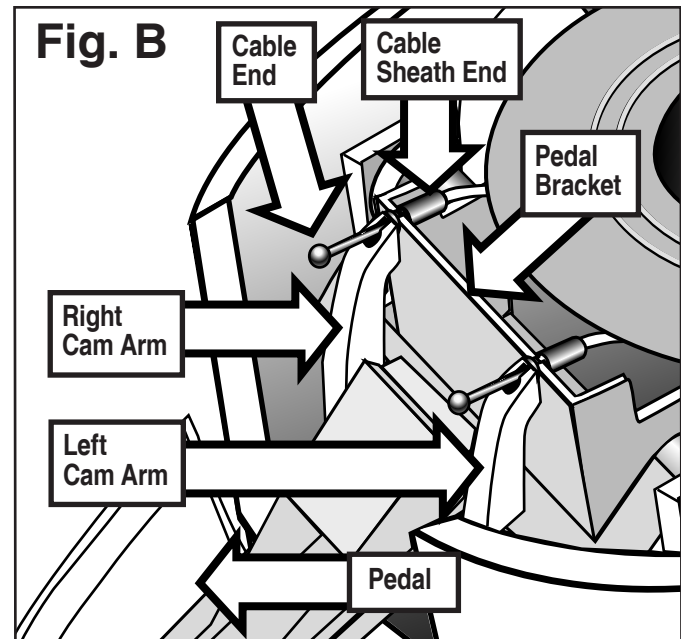
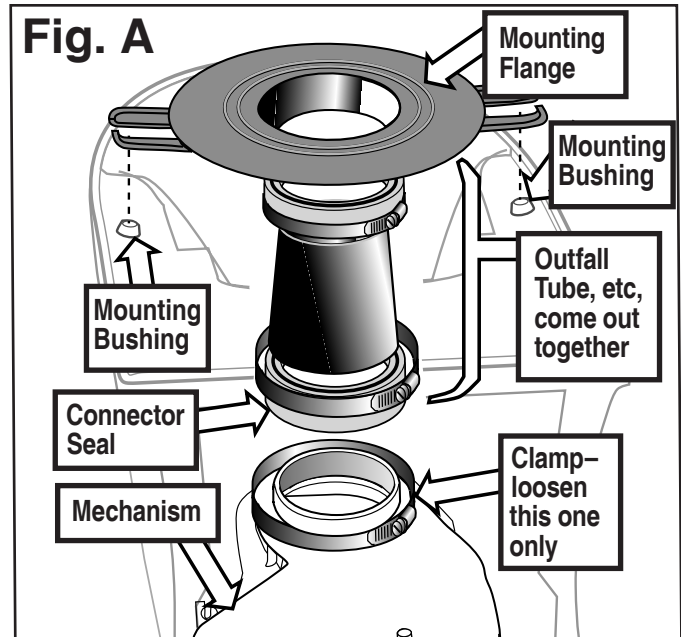

slots in Mechanism Plate.

8. Unhook right-side Cable from Water Valve Actuator. Discard Cable.
9. Insert new Cable end in Water Valve Actuator. Snap Cable Sheath fitting firmly into right-side slot in Mechanism Plate (Fig. D).
10. Remove left-side Cable. Unhook from Blade actuator and discard. Replace with new Cable in same position as before. Snap Cable firmly into left-side slot in Mechanism Plate (Fig. D).
11. Replace standoff screw (Fig. D).
12. Replace 3 other screws (Fig. C) to resecure Mechanism to Mechanism Plate.
11. Snap Cable Sheath Fittings into slots on Pedal Bracket (Fig. B). Secure by tapping into place with screwdriver.
12. Rotate Blade Actuator (Fig. D) to open valve and give slack on Cable. Engage Cable end to left Pedal Arm and release Blade Actuator.
13. Rotate Water Valve Actuator (Fig. D) to open Valve and give slack on Cable. Engage Cable end to Pedal Arm and release Water Valve Actuator.

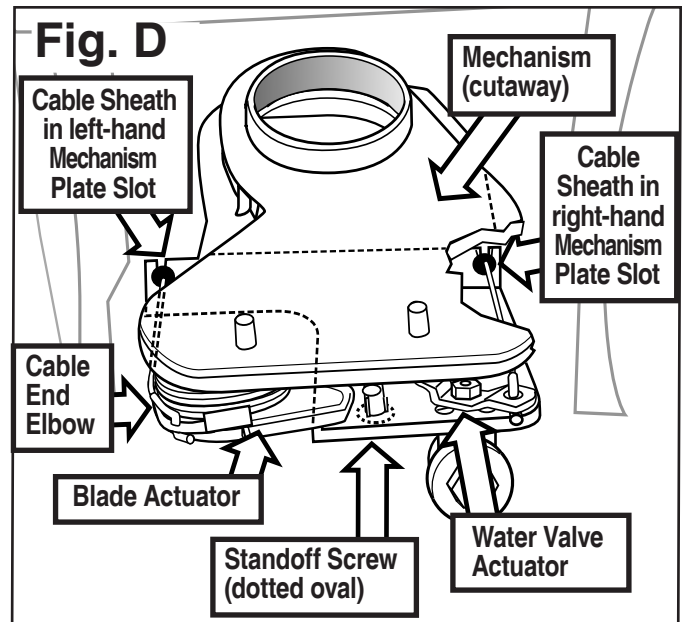

To Reinstall Toilet To Floor

1. Install new Closet Flange Seal to Toilet Mounting Flange, lip side outward. Friction holds it in place.
2. Keeping Mechanism Blade open to assure holes line up, position Toilet over Closet Flange.
3. Reconnect Water Supply Line.
4. Bolt Toilet to floor with Lag Screws. Tighten.
5. Turn on RV's water supply. Flush test. Fill bowl and make sure it holds water.
6. Install Bolt Caps.
 1. Remove Cables from Cam Arms.
 2. Facing front of toilet, use screwdriver to pry out left side of Pedal Arm at pivot point in Pedal Bracket.
 3. Remove Pedal. Discard.
 2. Position Toilet over Flange.
 3. Reconnect Water Supply Line.
 4. Secure to floor with Lag Screws. Tighten.
 5. Turn on RV's water supply. Flush test.
 6. Resecure Bolt Caps.