

Nozzle Assembly Package

Part #19626

Tools needed

- Phillips Screwdriver
- Wide-blade, Flat-blade screwdriver
- Adjustable Wrench

Notes:

- Read all instructions before beginning work.
- Clear Silicone Sealant, not supplied in this package, is required.

To Remove Toilet From Floor

1. Turn off RV water supply per RV Owner's Manual.
2. Press both keypad buttons at the same time, twice, to open blade and drain bowl of water.
3. Pry off Bolt Caps with Flat-blade screwdriver. Use wrench to remove 1/2-inch Lag Screws.
4. Swivel Toilet to gain access to back.
5. Turn off RV's power supply to the Toilet (Fig. A).
6. Disconnect Water Supply Line with Adjustable Wrench.
7. Disconnect Toilet's 12-volt power hookup to RV.
8. Place an old towel or soft cloth on work surface. Remove Toilet from floor and place upright, with back facing you, on work surface.
9. Remove old Closet Flange Seal (may be found in toilet or in floor at Closet Flange). Discard.
10. Cover Holding Tank opening to contain odor.

To Remove Old Parts

1. Disconnect 2 upper Tubes from outside Nozzle Connectors (Fig. B).
2. Cut Tie Strap securing Solenoid Valve to Metal Bracket (Fig. A).
3. Being careful not to bend Metal Bracket, slide Solenoid Valve out of slot in Bracket. Swing entire Valve/Hose Assembly down and to right out of the way. Support it to avoid putting stress on the Wire Harness.
4. Pop up Seat/Lid Bolt Covers (hinged from rear).
5. Holding Hinge Post Nuts from inside (Fig. B), turn screwdriver counterclockwise to unscrew Hinge Posts. Remove Nuts and Bolts (but not Seat/Lid).
6. Take note of Overflow Tube position if present (pre 3-16-03) for future reference. Pull Overflow Tube off center Nozzle Connector.
7. To remove 2 outside Nozzle Connectors, push them in, twist counterclockwise and pull back. (They may be caulked tight

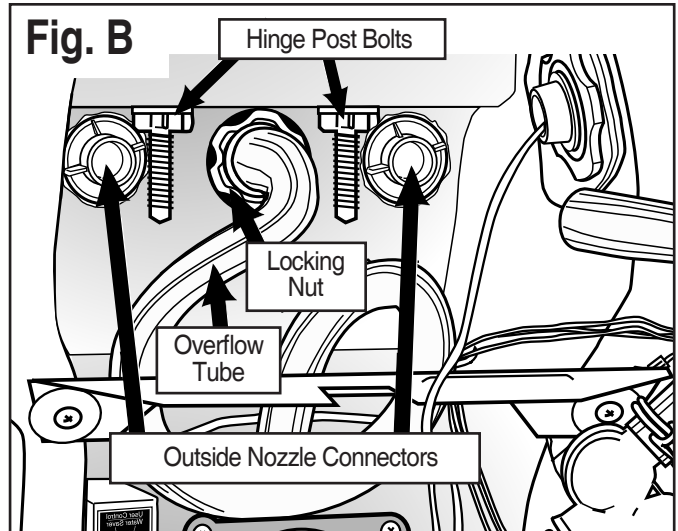
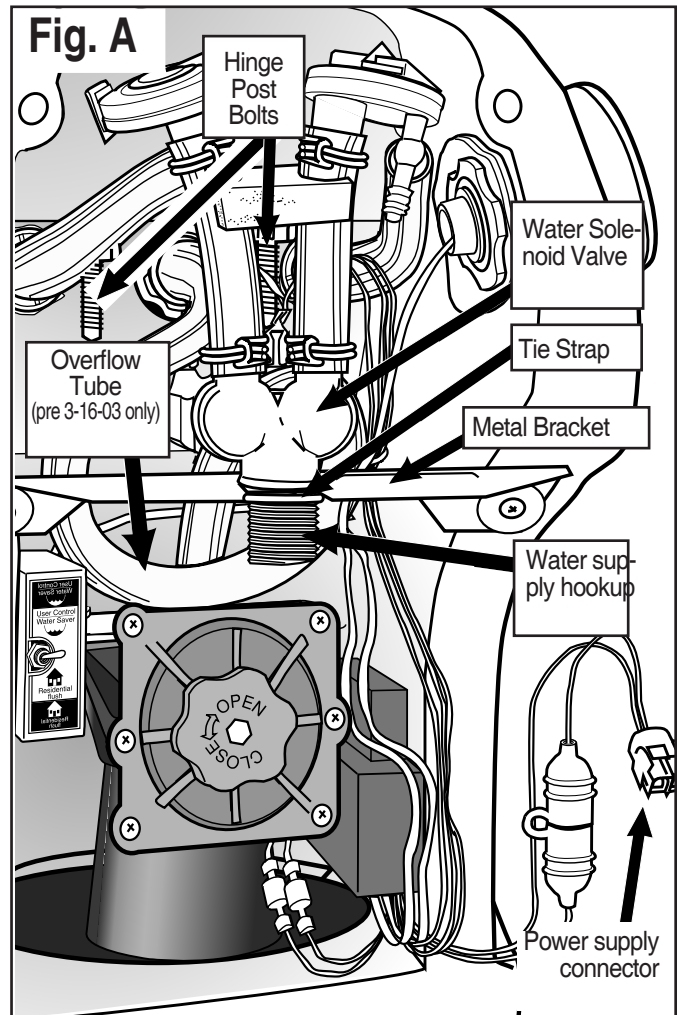

and difficult to remove. Use pliers if necessary.) Discard Nozzle Connectors.

8. Remove Locking Nut from center Nozzle by turning counter-

Part #19626

Nozzle Assembly Package *Continued*

clockwise until it releases. Save Locking Nut.

9. Push/pull old Flush Cover away through bowl. Discard.
10. Scrape away 3 Seals and Sealant with a sharp-edged tool. Use mineral spirits to remove **all** residue.

To Replace Part

1. Apply a small bead of Clear Silicone Sealant (not supplied) to one side of Gasket (Fig. C). With Sealant side down, position over Nozzle Assembly. Press down to seat.
2. Push small Foam Seal over Flush Cover barb. Position new Flush Cover/Nozzle Assembly in bowl. (Be sure Foam Seal is stuffed completely/flush into opening.)
3. Apply Silicone Sealant to 3 Nozzle Seals. Adhere them to Toilet, one around each Nozzle.
4. Apply Silicone Sealant to another Nozzle Seal. Adhere it to the Seal already in place around center Nozzle.
5. Apply Silicone Sealant to flat side of Locking Nut. With flat side facing seals, place Locking Nut on center Nozzle. Holding Nozzle Assembly firmly in position from inside Toilet Bowl, Turn Locking Nut clockwise to lock. (**Note:** all 4 prongs must mate with locking ears to achieve proper lock.)
6. Apply Silicone Sealant to last 2 Nozzles. Adhere Nozzles to Connectors. Again Holding Nozzle Assembly firmly, push in hard and rotate clockwise (you will feel it lock).
7. Before Sealant sets, be sure to Nozzle to China Seal is uniform.
8. Reattach center Overflow Tube (if present; see above). Tuck in Tube. To form a water trap, it must be curved at approximately same position as when removed.
9. Before Sealant sets, align/adjust Flush Cover/Nozzle Assembly level to Toilet inside bowl.
10. Align Seat/Cover Assembly. Replace Hinge Posts and reattach Nuts. Tighten firmly (Fig. B).
11. Swing entire Valve/Hose Assembly upright. Holding Metal Bracket firmly to avoid bending it, slide Solenoid Valve back into slot in Bracket. Rearrange Wire Harness.

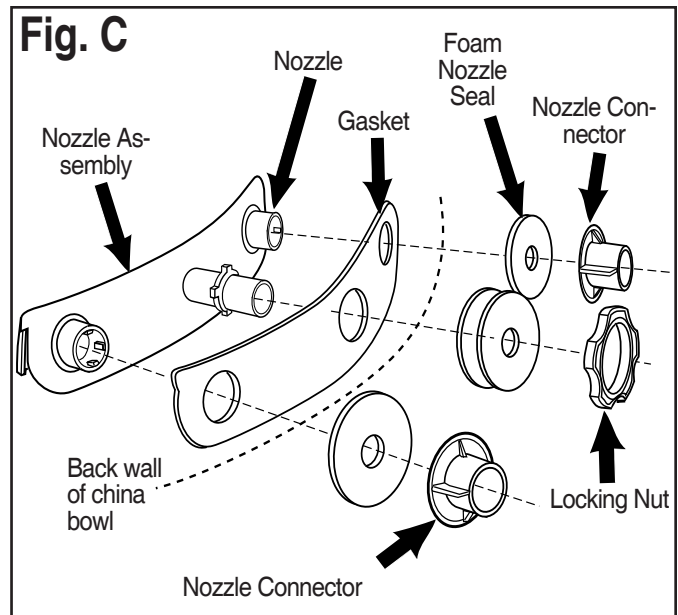

12. Reconnect Hoses to outside Flush Nozzles. Push on firmly (Fig. B).
13. Attach new Tie Strap holding Solenoid Valve to Metal Bracket (Fig. A).

To Replace Toilet To Floor

1. Secure new Closet Flange Seal, lip side up, to Toilet.
2. Position Toilet over flange.
3. Reconnect Water Supply Line.
4. Reconnect 12-volt power supply to Toilet.
5. Reconnect RV's power supply to the Toilet.
6. Turn on RV's water supply. Press Toilet flush button to close blade and to flush test.
7. Secure to floor with Lag Screws. Tighten.
8. Resecure Bolt Caps.